

200 Series

BUTTERFLY VALVES



Butterfly Valves

Whether you need manually or pneumatically controlled butterfly valves for pipeline installation or preassembled valve manifolds, the Waukesha Cherry-Burrell 200 series from SPX FLOW is the answer. These are a robust and reliable shut-off element with a long service life.

Butterfly Valves offer great durability, economy and ease of use for a wide range of applications. Easy to install and maintain, butterfly valves close under pressure to form a leak-tight seal, plus have the ability to throttle flow with a positioner.

SPX FLOW, Inc. (NYSE:FLOW) is a leading manufacturer of innovative flow technologies, many of which help define the industry standard in the market segments they serve. From its headquarters in Charlotte, North Carolina, it operates a sales and support network, centers of manufacturing excellence, and advanced engineering facilities, throughout the world. Its cutting-edge flow components and process equipment portfolio includes a wide range of pumps, valves, heat exchangers, mixers, homogenizers, separators, filters, UHT, and drying technology that meet many application needs. Its expert engineering capability also makes it a premium supplier of customized solutions and complete, turn-key packages to meet the most exacting of installation demands.

Incorporating many leading brands, SPX FLOW has a long history of serving the food and beverage, power and energy, and industrial market sectors. Its designs and engineered solutions help customers drive efficiency and productivity, increase quality and reliability, and meet the latest regulatory demands. In-depth understanding of applications and processes, state-of-the-art Innovation Centers, and advanced pilot/testing technology further assist in optimizing processes and reducing timescales to reliably meet production targets.

To learn more about SPX FLOW capabilities, its latest technology innovations and complete service offerings, please visit www.spxflow.com.

PRODUCT FEATURES AND BENEFITS

- All Stainless Construction: Forged, precision-machined body and electropolished disc
- Sanitary surface finish
- FDA-Approved materials: choice of elastomeric seats
- Complete line of manual and air actuators with control top options
- Symmetric, metal-to-metal body interface will not over-compress body gasket
- Visual indication of open/closed position
- Open bottom stem seal for positive leak detection

PRODUCT SPECIFICATIONS

Materials:

Disc and Body:

- 316 stainless steel with sanitary finish

Seal:

- EPDM, FKM, Silicone

Internal Surface Finish:

- ≤ 32 Ra ($\leq 0.8\mu$) - *Other finishes available upon request*

Sizes:

- 1/2" - 6" (12mm - 152mm) S-Line or Weld

Pressure Ratings:

Operating Pressure: Maximum line and control air pressure 150 psi (10 bar)

Temperature Ratings:

- EPDM, FKM, Silicone : 200°F (93°C)

PRODUCT DIMENSIONS

S-Line Connections

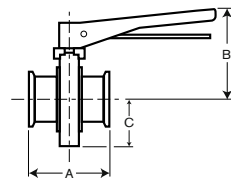

Weld Connections

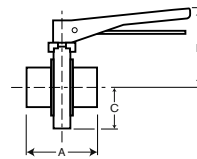

SIZE INCHES (MM)	A	B	C
1.00 (25)	2.50 (63)	3.75 (95)	1.65 (41)
1.50 (38)	2.81 (71)	4.00 (101)	1.89 (48)
2.00 (50)	2.81 (71)	4.25 (108)	2.17 (55)
2.50 (63)	3.00 (76)	4.63 (117)	2.50 (63)
3.00 (76)	3.93 (99)	4.88 (124)	2.80 (71)
4.00 (101)	4.09 (103)	5.22 (132)	3.19 (81)
6.00 (152)	4.56 (115)	7.64 (194)	4.53 (115)

SIZE INCHES (MM)	D1 [NO CT]	D2 [CU4 CT]	D3 [WCB CT]
1.00 (25)	9.83 (250)	16.90 (429)	16.64 (423)
1.50 (38)	10.07 (256)	17.15 (435)	16.88 (429)
2.00 (50)	10.38 (264)	17.45 (443)	17.19 (437)
2.50 (63)	10.71 (272)	17.79 (452)	17.53 (445)
3.00 (76)	11.00 (280)	18.07 (459)	17.81 (453)
4.00 (101)	13.90 (353)	21.01 (534)	20.75 (527)
6.00 (152)	15.24 (387)	22.35 (568)	22.09 (561)

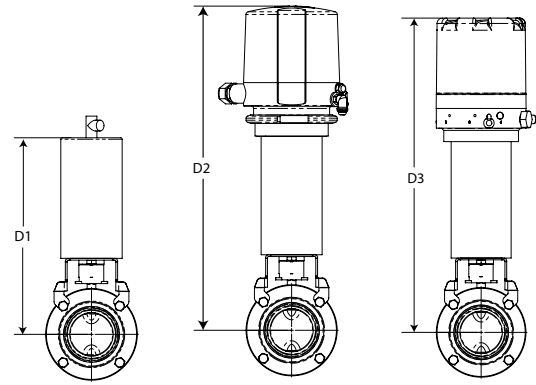

OPTIONS AND ACCESSORIES:

Manual Handle Options

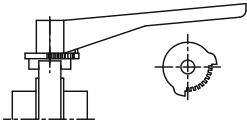

**Intermediate (9-position)
Handle**

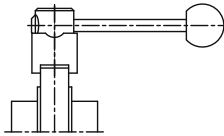

Pull-Style Handle

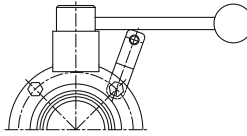

**Pull-Style Handle with
Padlock Travel Stop**

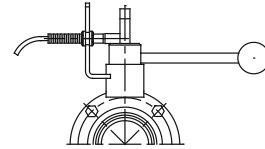

Pull-Style Handle for Switch(es)

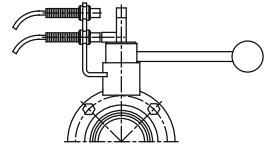

Control Top Options

Control Tops - APV



Connector Options

- S/O Cord Grip for hard wire (std)
- Quick Disconnect Pin Connectors
- Interface Options
- AS-i® Fieldbus Card
- Profibus and DeviceNet® (CU3)

Position Indication

- 2 internal feedback sensor switches for valve open/valve closed position detection

Solenoid Valves

- 24V DC
- Select 1 Solenoid or Solenoid with NOT-Element (Air/Air)

Features

- NEMA 6 (IP67)

Control Tops - WCB



Connector Options

- S/O Cord Grip for hard wire (std)
- Quick Disconnect Pin Connectors

Interface Options

- AS-i® Fieldbus Card
- DeviceNet® Field Bus Network Card

Position Indication

- Set and Forget programmable linear switch
- Inductive Proximity Switches - 20-140V AC/DC, 2-Wire (Std)
- Microswitches 24VDC, 110VAC
- Intrinsically safe options 5-24VDC
- Externally mounted options

Solenoid Valves

- 24V DC or 110V AC
- Select 1, 2 or 3 Solenoids
- Intrinsically safe option 24V DC

Features

- NEMA 4x (IP56)
- Stainless Steel Control Top Option

Proximity Switch Only

- Available with manual handle and pneumatic actuators
- Yoke mounted 10-30 VDC prox sensors with LED
- Feedback for valve open/valve closed position detection

Electropneumatic Positioner

- 4-20mA feedback signal
- Throttle/Control flow
- LCD display and simple set-up
- Optional DeviceNet®, Profibus or As-i® Communication



SPX FLOW

8681 CONTROL TOP



FEATURES AND BENEFITS

- Contact free position sensor including (3) programmable feedback signals
- Positions easily taught via intuitive push buttons or Autotune feature to ensure quick & easy set-up
- Ultra-bright 360° visual LED position indication with adjustable red, yellow, & green color assignments provide clarity from all points of view and avoid confusion
- Manual override and air throttle adjustable solenoids to assist start-up, maintenance, and troubleshooting
- Up to IP69K washdown rating available (IP65/67 as standard) for high washdown environments
- Built-in microcontroller tracks cycles and alerts operator when preventive maintenance is required
- Simple and robust stainless steel adapter & chemically resistant polycarbonate head
- Similar price as WCB control tops
- Supplied by industry leading Burkert Fluid Controls

Connector Options

- S/O Cord Grip for hard wire (STD)
- Quick Disconnect Pin Connectors

Position Indication

- (3) programmable position sensors in control top

Solenoid Valves

- 24V DC or 110V AC
- Manual override and air throttle adjustment
- Up to (3) available in control top

Interface Options

- AS-i Field® Bus Card
- DeviceNet® Field Bus Network Card

SPX FLOW

611 Sugar Creek Road

Delavan, WI 53115

P: (262) 728-1900 or (800) 252-5200

F: (262) 728-4904 or (800) 252-5012

E: wcb@spxflow.com

SPX FLOW reserves the right to incorporate our latest design and material changes without notice or obligation.

Design features, materials of construction and dimensional data, as described in this bulletin, are provided for your information only and should not be relied upon unless confirmed in writing. Please contact your local sales representative for product availability in your region. For more information visit www.spxflow.com.

The green ">" is a trademark of SPX FLOW, Inc.