

Multistage High-Pressure

200MS SERIES CENTRIFUGAL PUMPS



The Waukesha Cherry-Burrell 200 Series, Heavy-Duty Centrifugals set a new standard for higher efficiency, minimal vibration and longer life. Many of the same features of the 200 Series pumps, including strong investment cast impellers, low NPSH requirements and tighter running clearances, have been included in the 200MS high-pressure multistage.

SPX FLOW, Inc. (NYSE:FLOW) is a leading manufacturer of innovative flow technologies, many of which help define the industry standard in the market segments they serve. From its headquarters in Charlotte, North Carolina, it operates a sales and support network, centers of manufacturing excellence, and advanced engineering facilities, throughout the world. Its cutting-edge flow components and process equipment portfolio includes a wide range of pumps, valves, heat exchangers, mixers, homogenizers, separators, filters, UHT, and drying technology that meet many application needs. Its expert engineering capability also makes it a premium supplier of customized solutions and complete, turn-key packages to meet the most exacting of installation demands.

Incorporating many leading brands, SPX FLOW has a long history of serving the food and beverage, power and energy, and industrial market sectors. Its designs and engineered solutions help customers drive efficiency and productivity, increase quality and reliability, and meet the latest regulatory demands. In-depth understanding of applications and processes, state-of-the-art Innovation Centers, and advanced pilot/testing technology further assist in optimizing processes and reducing timescales to reliably meet production targets.

To learn more about SPX FLOW capabilities, its latest technology innovations and complete service offerings, please visit www.spxflow.com.

200MS Series High-Pressure Multistage Centrifugal Pumps:

THE SMOOTHER FLOWING, HIGH-EFFICIENCY, COST SAVING ALTERNATIVE FOR HIGH-PRESSURE APPLICATIONS

Especially designed for recirculating service in reverse osmosis and other membrane systems, the 200MS Series pumps offer lower start-up and run costs due to the high efficiency two impeller design. Moreover, they produce a smooth, constant flow rate that reduces RO membrane fouling.

The 200MS Series pumps are equipped with a balanced, double-shaft seal with buffer fluid ports on top and bottom for complete removal of air/vapor from the seal chamber.

FEATURES AND BENEFITS

- Cost competitive two stage design.
- High efficiency and low noise; precision, heavy-duty, machined cover and diffuser manufactured to tight tolerances.
- Easier on RO membranes than piston pumps with a smooth, constant, flow rate and less membrane fouling.
- Up to 250 psi (17 bar) pump differential pressure.
- Up to 1250 psi (86 bar) maximum casing pressure when pumps are placed in series.
- Sanitary 3-A construction for dairy and food processing; wet end parts 316L stainless steel.
- Clean-In-Place (CIP).
- Save on maintenance costs; uses many common components with 200 Series pumps; easy takedown and assembly shortens downtimes.
- Flush type seal, standard.

Long-life features

- Negligible shaft deflection due to rigid shaft.
- Large, long-life bearings with non-wearing, labyrinth seals.
- Coupling wear reduced by motor flange adapter design.

Typical product applications

Balance, double-shaft seal

Liquid-cooled rotary, double seal features two silicon carbide seals fully enclosed with a stainless steel seal housing. Liquid coolant circulates through the housing under moderate pressure to cool seal surfaces.

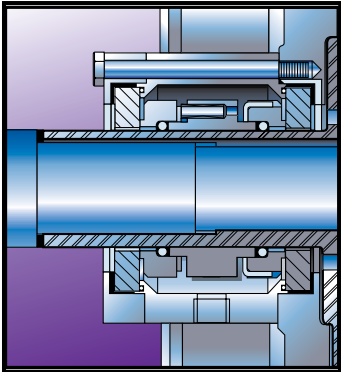

Reverse Osmosis systems

- Whey Separation
- Food plant waste streams
- Water treatment



Water boost & recirculation in commercial buildings

Sanitizing systems



Machine coolants

Heavy-duty, cast iron bearing frame keeps shaft rigid and concentric for long seal and bearing life

S-clamp fittings are standard. Other connections available upon request

Precision, computer designed diffuser efficiently channels water between stages

Heavy stainless steel cover is precision machined from bar stock

Balanced, water flush, double-shaft seal (not shown)

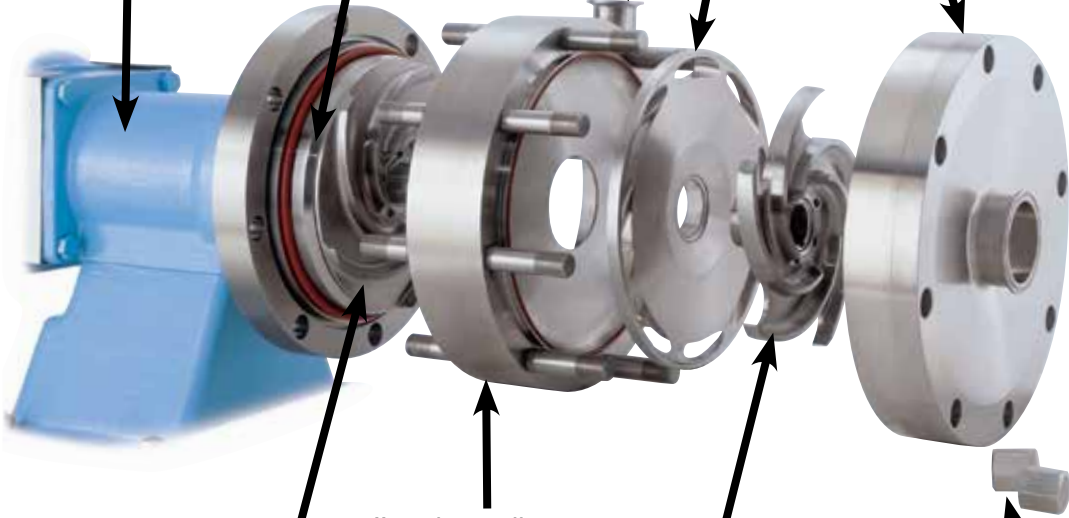

#2 impeller acts as a pressure building 2nd pump in series

Heavy intermediate casing separates the two impeller stages

Low NPSHR investment cast impeller features 5-bladed, open design for easy CIP and gentle product handling

Heavy stainless steel hex nuts for quick access and disassembly

SPXFLOW

PERFORMANCE CURVES

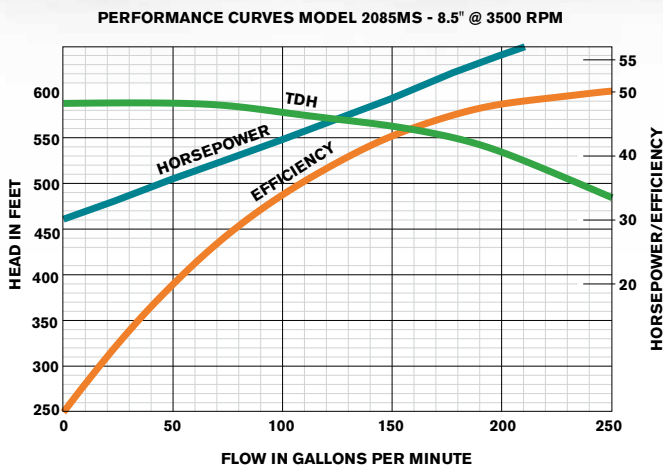

2085MS DIMENSIONS

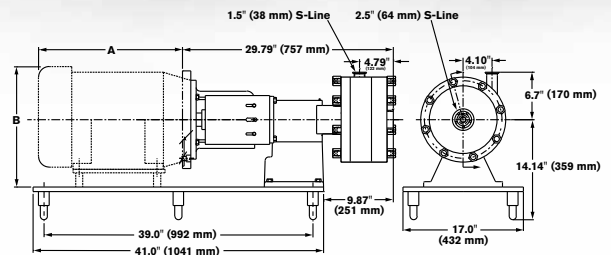

HP	FRAME	A in (mm)	B in (mm)
20	256TC	19.75 (502)	16.15 (410)
25	284TC	20.25 (514)	21.95 (558)
30	286TC	21.75 (552)	22.70 (577)
40	324TC	23.50 (570)	23.90 (607)
50	326TC	25.00 (635)	24.60 (625)
60	364TC	25.70 (653)	25.30 (643)

Based in Charlotte, North Carolina, SPX FLOW, Inc. (NYSE: FLOW) is a multi-industry manufacturing leader. For more information, please visit www.spxflow.com

SPX FLOW

611 Sugar Creek Road

Delavan, WI 53115

P: (262) 728-1900 or (800) 252-5200

F: (262) 728-4904 or (800) 252-5012

E: wcb@spxflow.com



SPX FLOW, Inc. reserves the right to incorporate our latest design and material changes without notice or obligation.

Design features, materials of construction and dimensional data, as described in this bulletin, are provided for your information only and should not be relied upon unless confirmed in writing. Please contact your local sales representative for product availability in your region. For more information visit www.spxflow.com.

The green "s" and "x" are trademarks of SPX FLOW, Inc.

ISSUED 08/2016 FH-1703

COPYRIGHT © 2016 SPX FLOW, Inc.